

# Illustration for led panel light installation

----- Recessed

## Material composition

x6 pcs

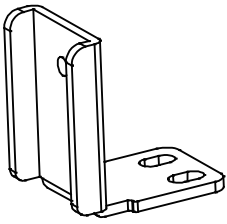

L shape Bracket

x6 pcs

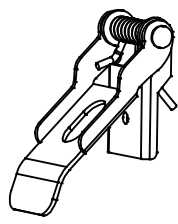

Spring Hanger

x12 pcs

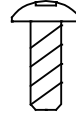

M3\*8.5 screw

x6 pcs



M3\*6.5 screw

## Installation

- ① Remove the original screws of this positions

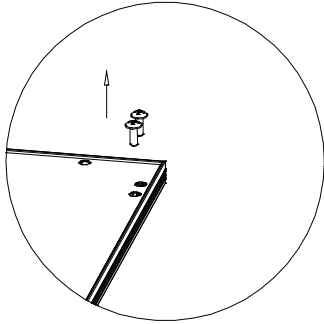

- ② Fix the L shaper bracket with M3\*8.5 self-tapping screws

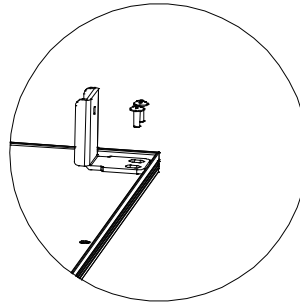

- ③ Connect the L shape Bracket and Spring hanger by M3\*6.5 screw

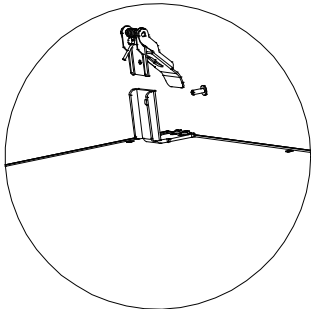

- ④ Stretch the four spring hangers and insert onto the backside of roof

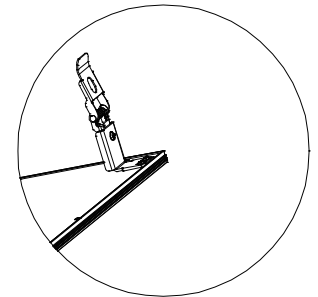
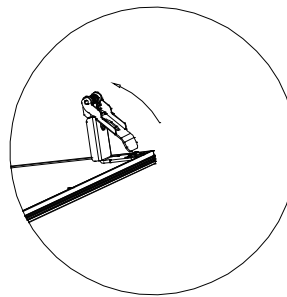

- ⑤ Completed

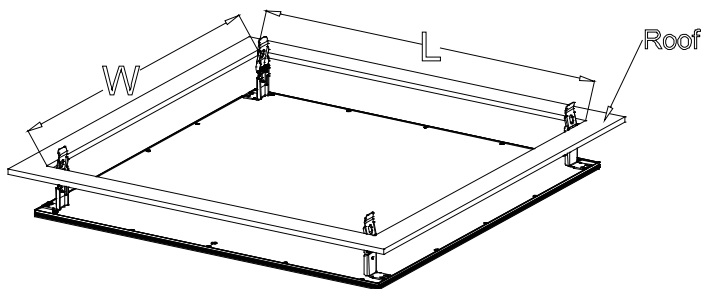

size of panel (mm)	L*W(mm) Mounting Dimensions
295*1195	267*1167

